

UNION TOWNSHIP SECTION 15 R 13 TWP 8 MORGAN COUNTY, OHIO

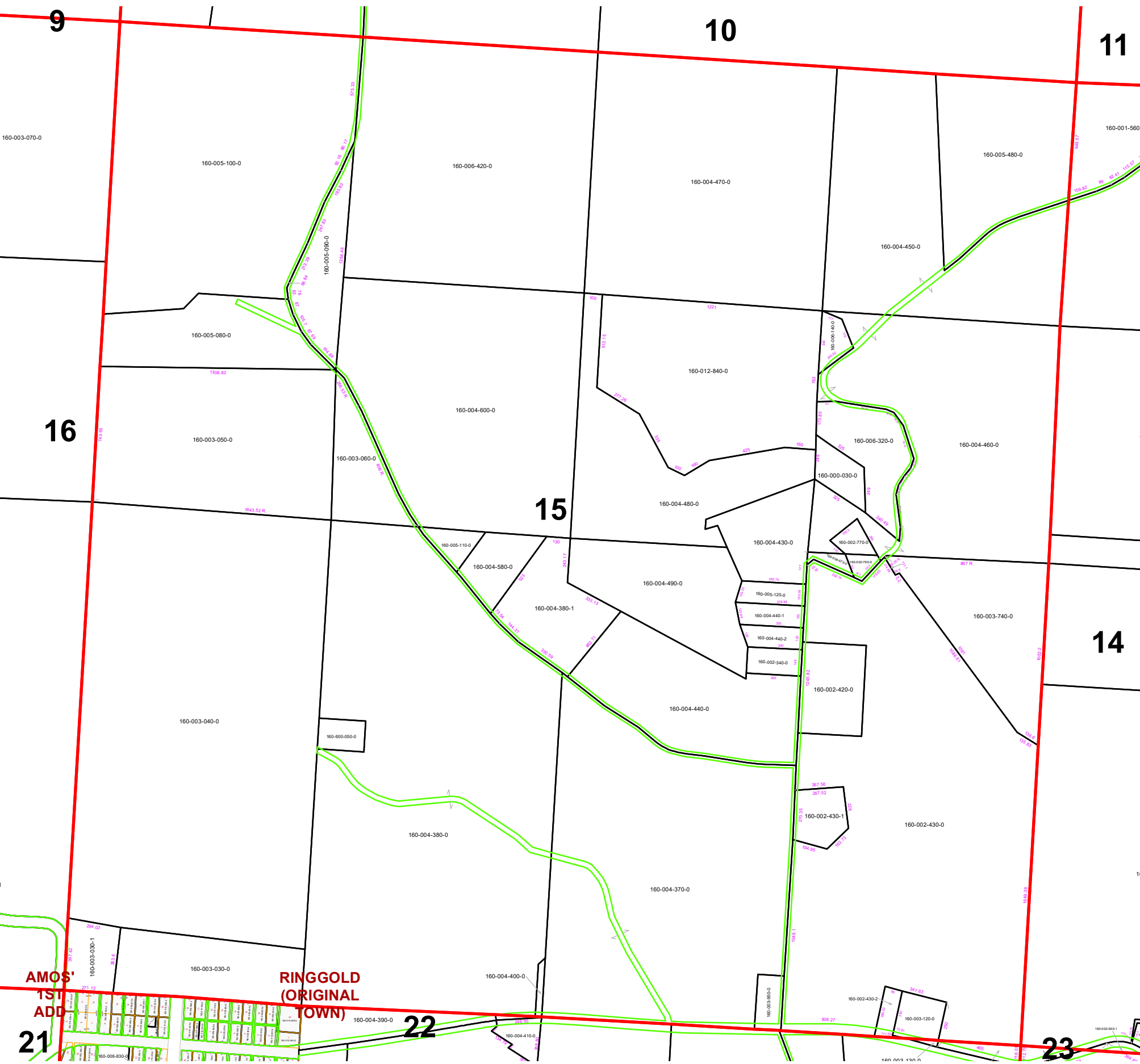

| PIN | Owner | LegalDescr | Acres | VOL | PAGE | Survey_Ref |
|---------------|-----------------------------------|-----------------------|--------|---------|------|--------------|
| 160-005-090-0 | BROWN RANDY | R13 T08 S15 SD 13 | 4.848 | OR181 | 161 | UNN-0263.pdf |
| 160-003-950-0 | CAIN ANGELA MARIE | R13 T08 S15 SD 23 | 1 | OR231 | 4126 | NoSurvey.pdf |
| 160-600-050-0 | CEMETERY (FAIRVIEW) RINGGOLD | R13 T08 S15 LOT 15 | 1 | | | NoSurvey.pdf |
| 160-004-380-1 | DOWNARD PAUL D JR & BETHANY D | R13 T08 S15 SD 40 SUR | 6.253 | OR161 | 67 | UNN-0253.pdf |
| 160-004-580-0 | DOWNARD PAUL D JR & BETHANY D | R13 T08 S15 SD 25 | 2.53 | D.V 75 | 344 | NoSurvey.pdf |
| 160-002-430-0 | DRAKE JEFFREY A & ANGELA D | R13 T08 S15 SD 10 | 60.031 | OR53 | 567 | UNN-0195.pdf |
| 160-002-420-0 | DRAKE JEFFREY A & ANGELA D | R13 T08 S15 SD 26 EX | 4 | OR53 | 567 | NoSurvey.pdf |
| 160-004-600-0 | GREENHILL NINA L | R13 T08 S15 SD 5 | 35.46 | OR16 | 387 | NoSurvey.pdf |
| 160-002-430-2 | KASLER ROGER P & EMERIA I TRUSTE | R13 T08 S15 SD 39 SUR | 0.61 | OR52 | 536 | UNN-0192.pdf |
| 160-003-120-0 | KASLER ROGER P & EMERIA I TRUSTE | R13 T08 S15 SD 18 | 1.41 | OR52 | 536 | NoSurvey.pdf |
| 160-005-120-0 | KING FRANCES J | R13 T08 S15 SD 27 | 1 | OR37 | 200 | NoSurvey.pdf |
| 160-004-440-2 | MARTIN BARBARA | R13 T08 S15 SD 37 EX | 0.895 | OR122 | 167 | UNN-0038.pdf |
| 160-004-440-1 | MARTIN BARBARA | R13 T08 S15 SD 36 EX | 1.005 | OR122 | 167 | UNN-0038.pdf |
| 160-003-740-0 | MAXWELL GLEN R & GWEN J | R13 T08 S15 SD 29 | 11.24 | D.V 158 | 375 | UNN-0033.pdf |
| 160-005-080-0 | NICESWANGER KEITH A | R13 T08 S15 SD 6 | 9.54 | OR182 | 448 | NoSurvey.pdf |
| 160-005-100-0 | NICESWANGER KEITH A | R13 T08 S15 SD 14 | 40 | OR182 | 448 | NoSurvey.pdf |
| 160-004-380-0 | NICHOLS VELMA PAULINE TRUST | R13 T08 S15 SD 15 | 72.148 | OR128 | 460 | NoSurvey.pdf |
| 160-004-400-0 | NICHOLS VELMA PAULINE TRUST | R13 T08 S15 SD 11 | 0.25 | OR128 | 460 | NoSurvey.pdf |
| 160-004-370-0 | NICHOLS VELMA PAULINE TRUST | R13 T08 S15 SD 9 | 45.46 | OR128 | 460 | NoSurvey.pdf |
| 160-004-440-0 | NICHOLS VELMA PAULINE TRUST | R13 T08 S15 SD 18 | 7.5 | OR128 | 460 | NoSurvey.pdf |
| 160-004-430-0 | NICHOLS VELMA PAULINE TRUST | R13 T08 S15 SD 3 | 4.84 | OR128 | 460 | NoSurvey.pdf |
| 160-004-570-0 | NICHOLS VELMA PAULINE TRUST | R13 T08 S15 SD 24 | 0.42 | OR128 | 460 | NoSurvey.pdf |
| 160-004-490-0 | NICHOLS VELMA PAULINE TRUST | R13 T08 S15 SD 17 SUR | 20.209 | OR128 | 460 | NoSurvey.pdf |
| 160-004-460-0 | NICHOLS VELMA PAULINE TRUST | R13 T08 S15 SD 1 | 35.85 | OR128 | 460 | NoSurvey.pdf |
| 160-004-480-0 | NICHOLS VELMA PAULINE TRUST | R13 T08 S15 SD 16 | 13.42 | OR128 | 460 | NoSurvey.pdf |
| 160-004-450-0 | NICHOLS VELMA PAULINE TRUST | R13 T08 S15 SD 12 | 20.94 | OR128 | 460 | NoSurvey.pdf |
| 160-004-470-0 | NICHOLS VELMA PAULINE TRUST | R13 T08 S15 SD 2 | 40 | OR128 | 460 | NoSurvey.pdf |
| 160-002-780-0 | NORTH WILLIAM E | R13 T08 S15 SD 35 | 0.43 | OR196 | 767 | UNN-0050.pdf |
| 160-002-770-0 | NORTH WILLIAM E | R13 T08 S15 SD 34 | 0.62 | OR196 | 767 | UNN-0050.pdf |
| 160-005-110-0 | PLUMMER DAVID L | R13 T08 S15 SD 21 | 1 | OR24 | 576 | NoSurvey.pdf |
| 160-012-840-0 | PLUMMER PHILIP G JR & CHRISTOPHER | R13 T08 S15 SUBDIVISI | 21.74 | OR9 | 624 | UNN-0087.pdf |
| 160-002-430-1 | SAYERS JEROLD B & TAMARA K | R13 T08 S15 SD 38 SUR | 1.984 | D.V 191 | 572 | UNN-0097.pdf |
| 160-006-140-0 | TANNER JOE D & BETTY L | R13 T08 S15 SD 33 EX | 0.89 | D.V 164 | 359 | UNN-0046.pdf |
| 160-003-060-0 | THOMPSON JOSEPH J | R13 T08 S15 SD 22 EX | 4.54 | OR230 | 2754 | UNN-0037.pdf |
| 160-003-050-0 | THOMPSON JOSEPH J | R13 T08 S15 SD 30 EX | 25.46 | OR230 | 2754 | UNN-0037.pdf |
| 160-005-480-0 | THOMPSON TIMOTHY J & STEFANIE | R13 T08 S15 SD 20 SUR | 14.06 | OR34 | 124 | NoSurvey.pdf |
| 160-003-030-0 | THOMPSON TIMOTHY J & STEFANIE D | R13 T08 S15 SD 7 SUR | 6.358 | OR225 | 3152 | NoSurvey.pdf |
| 160-003-040-0 | THOMPSON TIMOTHY J & STEFANIE D | R13 T08 S15 SD 20 SUR | 70.18 | OR225 | 3152 | NoSurvey.pdf |
| 160-006-320-0 | TILTON ELIJAH G & GINA L | R13 T08 S15 SD 32 OIL | 4.685 | OR231 | 4476 | UNN-0342.pdf |
| 160-003-030-1 | UNION TOWNSHIP TRUSTEE'S | R13 T08 S15 SD 41 | 2.462 | OR208 | 712 | UNN-0295.pdf |
| 160-000-030-0 | UPOLE DONALD LEE JR & DONALD LE | R13 T08 S15 SD 28 EX | 1.638 | OR231 | 1643 | UNN-0326.pdf |
| 160-002-340-0 | WALKER ROBERT F | R13 T08 S15 SD 31 | 1 | OR160 | 766 | UNN-0038.pdf |
| 160-006-420-0 | YODER DAVID | R13 T08 S15 SD 4 | 40 | OR235 | 4909 | NoSurvey.pdf |

AMOS' 1ST ADD
RINGGOLD (ORIGINAL TOWN)

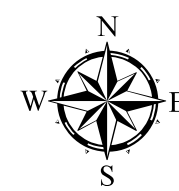

| Boundaries | |
|------------|----------|
| | Hydro |
| | Section |
| | Roads |
| | Lot |
| | County |
| | Parcel |
| | ROW |
| | Township |



Source: Morgan County Engineer's Office
Author: Marcia Wolfe
Date: 02/10/20

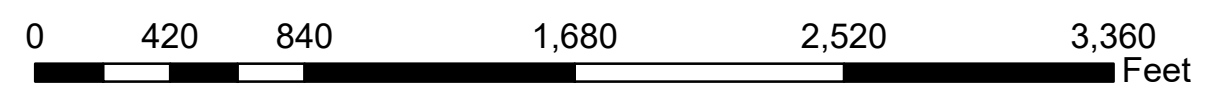

Disclaimer: The information that these maps contains is for reference purposes only. Please bring any erros to the attention of the Engineer's Office staff. Thank you